

The perfect low moisture cleaning method for heavy traffic areas



Sprinkle **DriWay+®** Compound generously over a 5' x 5' carpeted area to be cleaned.



Agitate with a Dri-Way Jr. machine using a back and forth and crosswise motion working the compound into the carpet nap.



Allow area to dry while proceeding with another 5 ft. x 5 ft. area. Vacuum entire carpet with brush type upright vacuum.



Dri-Way+® Compound coverage is 550-650 square feet per 5 lb., depending on the type of carpet.

Our **Dri-Way Jr.** machines twin, counter rotating brushes will gently work the **Dri-Way+®** Compound into the carpet fibers. The process is so easy to use and takes little time to apply.

- 14" width head with a brush path of 12 1/2"
- Two counter rotating spinning brushes that will open the carpet pile, enabling the DriWay+® to clean each fiber
- The handle can be disconnected for portability and storage
- Weighs only 11 pounds
- 40' Cord

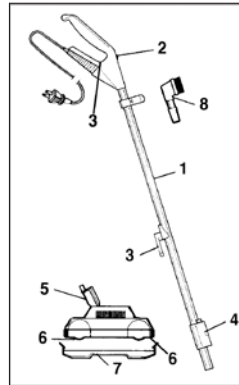

Identification of Parts

1. Handle
2. On/Off switch
3. Cable hooks
4. Handle connector
5. Swivel neck
6. Brushes
7. Storage tray
8. Spot cleaning brush

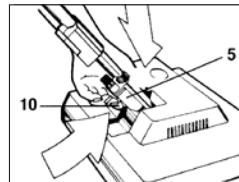
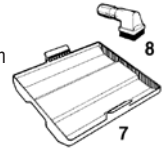

Assembly

Press the plunger button (10) and insert the handle (1) into the swivel neck (5). With the plunger button released, the handle should remain firmly engaged. Pushing the handle forward sets the handle into the storage position. Pulling back releases the handle into the operating position.

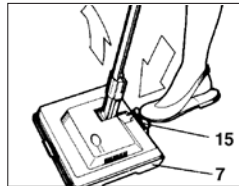

Operating Instructions

Before turning on your brush machine, remove the machine from the storage tray (7) by pressing down the catch (15) and lifting the machine upwards by the handle (figure 1). To replace the machine into the storage tray after use, first unplug the machine, then lower the head onto the tray until the tray snaps into place (figure 2).



Starting The Machine

Before turning on your brush machine, make sure that the storage tray has been removed (see above) and that you have a firm hold on the handle grip to keep the machine from moving forward.

1. Turn the quick release cable hook (14) to the up position by moving it to the left or right.
2. Release the power cord plug from the power cord and lift the cord (13) off of the upper cord hook.
3. With the switch (2) in the "O" (OFF) position, plug the polarized power cord into a 120 volt outlet located near the floor.

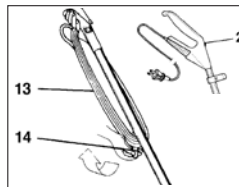

Switch Position **O = OFF I = ON**

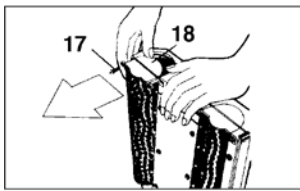

Figure 7

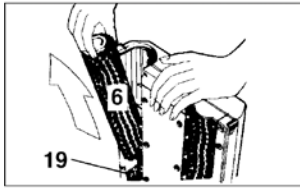

Figure 8

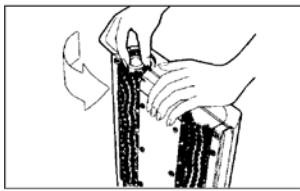

Figure 9

Maintenance

Always unplug brush machine from outlet before dismantling any part of machine!

Removing the Brushes to Change or Clean - Figures 7 & 8

Remove the brushes (6), by unscrewing the two screws (17) at the end of each brush from the bearing block (18). Do not remove the screws that are recessed. Push the top of the brush and the block forward at the same time. Take the block off the brush, then, lift the brush upwards out of the brush housing.

Cleaning the Brushes

The brushes must be removed from the machine to be thoroughly cleaned. See instructions above for removing the brushes. Clean by running your SEBO vacuum's suction hose, with crevice tool attached, up and down each brush to remove dirt and powder. Some carpet fibers, dirt and debris may require removal by hand. Replace the brushes - see instructions below. A cursory cleaning of the brushes may be done without removing them, by unplugging the machine, turning the brush rollers upright, and using your vacuum's suction hose, with crevice tool attached, to remove the loose dirt or powder.

Replacing the Brushes - Figures 8 & 9

To replace each brush, insert the end with the slots into the housing and locate the slots over the drive cog (19) by turning the brush. Push the brush forward slightly to enable the bearing block (18) to be replaced, then push the block back into place in the brush housing and replace the two screws (17).

Trouble-Shooting Guide		
Always unplug brush machine from outlet before dismantling any part of the machine!		
PROBLEM	REASON	SOLUTION
Does not turn on or machine shuts off intermittently	1. Handle not fully inserted into the housing, causing a faulty connection.	1. See page 5 for how to insert handle.
	2. Not plugged into good outlet.	2. Use another outlet.
	3. Cable worn.	3. Replace cable.
	4. Brush has not been reinserted properly.	4. See page 8 for how to replace brush.

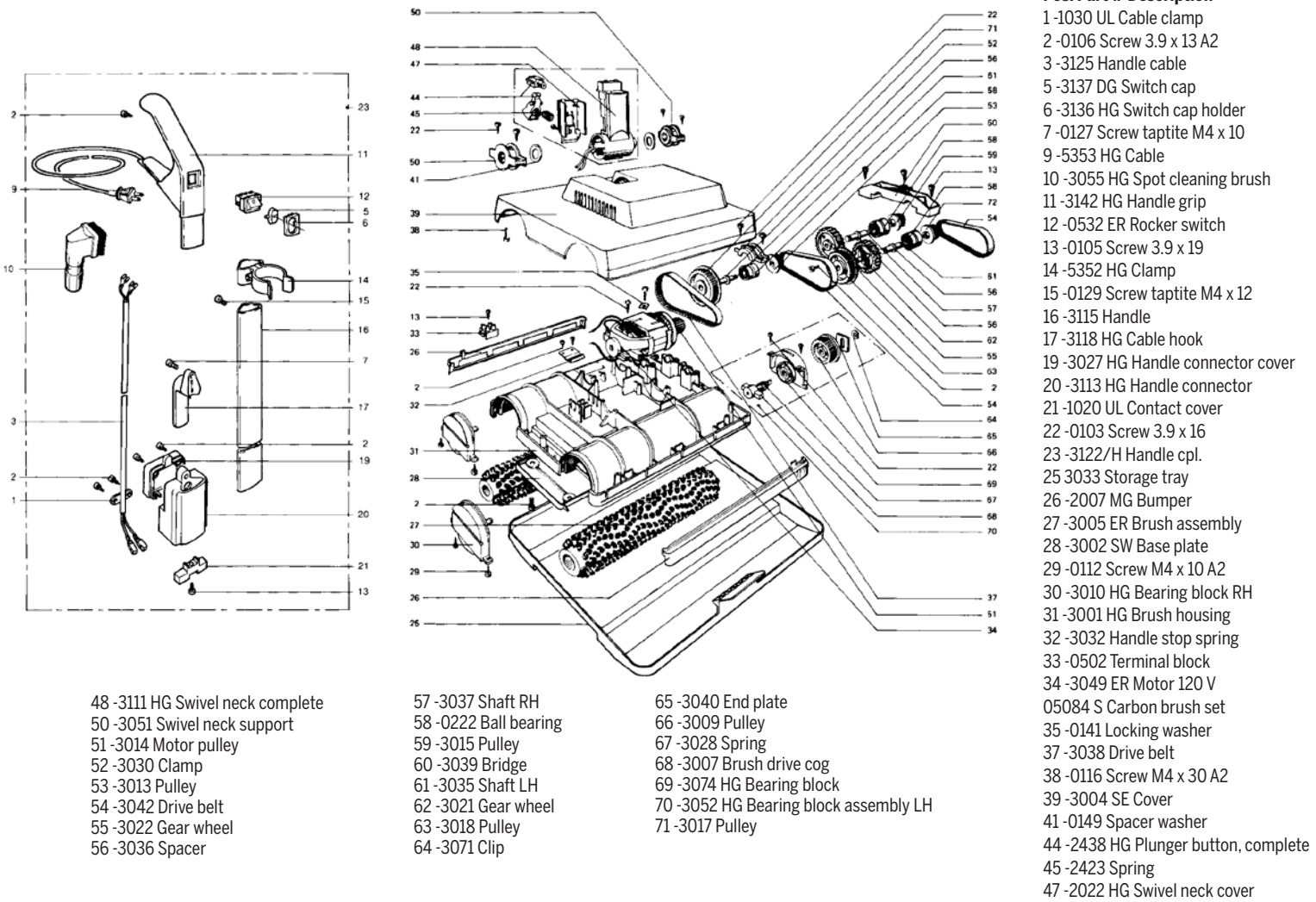

- Pos. Part # Description**
- 1 -1030 UL Cable clamp
 - 2 -0106 Screw 3.9 x 13 A2
 - 3 -3125 Handle cable
 - 5 -3137 DG Switch cap
 - 6 -3136 HG Switch cap holder
 - 7 -0127 Screw taptite M4 x 10
 - 9 -5353 HG Cable
 - 10 -3055 HG Spot cleaning brush
 - 11 -3142 HG Handle grip
 - 12 -0532 ER Rocker switch
 - 13 -0105 Screw 3.9 x 19
 - 14 -5352 HG Clamp
 - 15 -0129 Screw taptite M4 x 12
 - 16 -3115 Handle
 - 17 -3118 HG Cable hook
 - 19 -3027 HG Handle connector cover
 - 20 -3113 HG Handle connector
 - 21 -1020 UL Contact cover
 - 22 -0103 Screw 3.9 x 16
 - 23 -3122/H Handle cpl.
 - 25 3033 Storage tray
 - 26 -2007 MG Bumper
 - 27 -3005 ER Brush assembly
 - 28 -3002 SW Base plate
 - 29 -0112 Screw M4 x 10 A2
 - 30 -3010 HG Bearing block RH
 - 31 -3001 HG Brush housing
 - 32 -3032 Handle stop spring
 - 33 -0502 Terminal block
 - 34 -3049 ER Motor 120 V 05084 S Carbon brush set
 - 35 -0141 Locking washer
 - 37 -3038 Drive belt
 - 38 -0116 Screw M4 x 30 A2
 - 39 -3004 SE Cover
 - 41 -0149 Spacer washer
 - 44 -2438 HG Plunger button, complete
 - 45 -2423 Spring
 - 47 -2022 HG Swivel neck cover

- 48 -3111 HG Swivel neck complete
- 50 -3051 Swivel neck support
- 51 -3014 Motor pulley
- 52 -3030 Clamp
- 53 -3013 Pulley
- 54 -3042 Drive belt
- 55 -3022 Gear wheel
- 56 -3036 Spacer

- 57 -3037 Shaft RH
- 58 -0222 Ball bearing
- 59 -3015 Pulley
- 60 -3039 Bridge
- 61 -3035 Shaft LH
- 62 -3021 Gear wheel
- 63 -3018 Pulley
- 64 -3071 Clip

- 65 -3040 End plate
- 66 -3009 Pulley
- 67 -3028 Spring
- 68 -3007 Brush drive cog
- 69 -3074 HG Bearing block
- 70 -3052 HG Bearing block assembly LH
- 71 -3017 Pulley